

---

## One of Hottest for Polyethylene Fabric - Top-Rated Product! DC24V Electric Film Reeler Roll Up Units Winch for Poly Film Greenhouse Ventilation - Fenglong Greenhouse

What is Electric Film Reeler?

Electric Film Reeler, also known as Electric Roll Up Units, is widely used in poly greenhouse or livestock. Through opening or closing the greenhouse film by Electric film reeler, it allows you to properly control your greenhouse easier, like the ventilation, shading, humidity, air exchange and temperature. it is absolutely the trend for polyethylene greenhouse ventilation. It saves the man power and is quick to achieve ventilation and closing of the polyethylene coverings especially for multi span greenhouses.

Exported To 48 Countries:

Fenglong Kingzo® Electric Film Reeler has been serving customers in 48 countries since 2003.

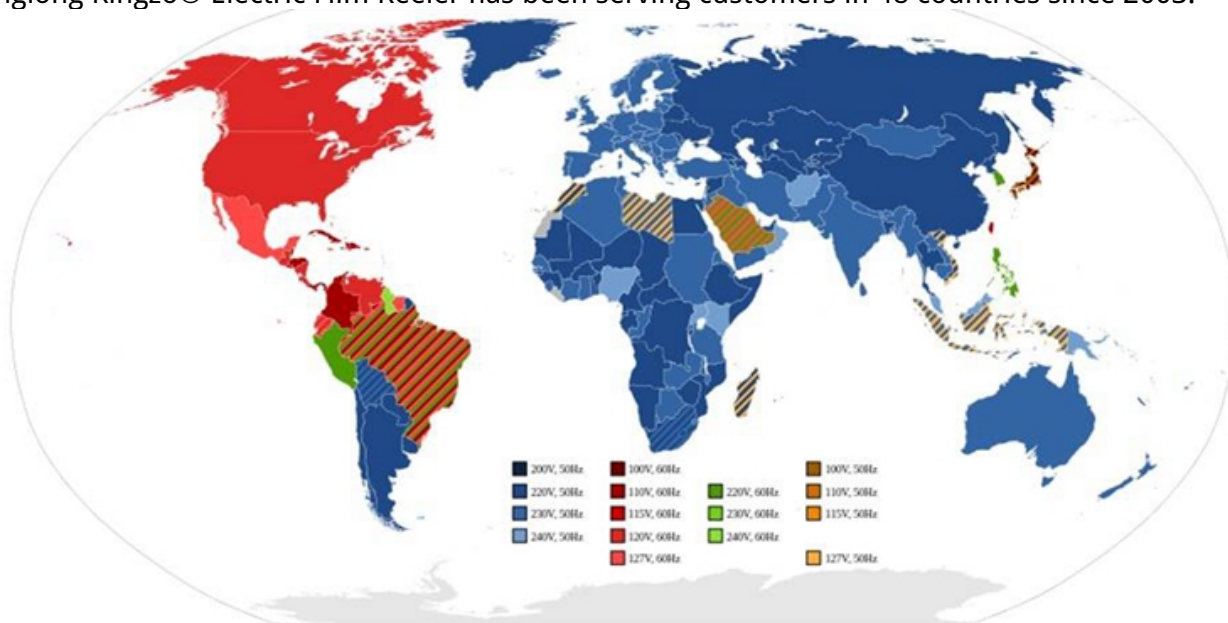

Development history of Electric Film Reeler

- 1) In 2003 the electrical film reeler was invented produced by Beijing Fenglong.
- 2) in 2006 the reelers were exported to Japan, USA, and more than 20 other countries.
- 3) in 2008 Japan bought 5000-10000 sets of reelers every year.
- 4) in 2013 Kingzo AC 220 reeler was invented, which was a technical innovation.
- 5) in 2017 film reelers sales qty has surpassed 80000 sets, and annual capacity is 150000 sets.

Continuous optimization, Scientific Streamline Design



---

Low Noise and Big Torque

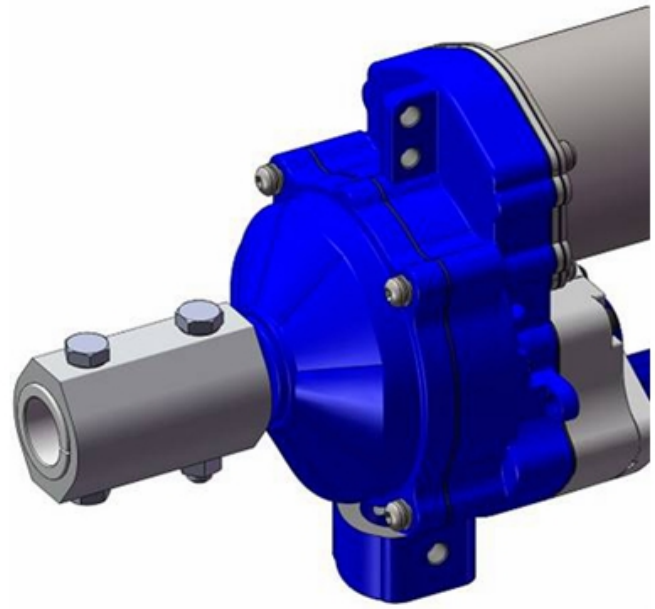

---

Easy to Install and Operate



---

#### Overload-proof

When the load is 1.5 times the rated torque, the overload protection device will start, the motor will stop, after 5-6 minutes, the motor will restart, this will prevent the motor from burning down.



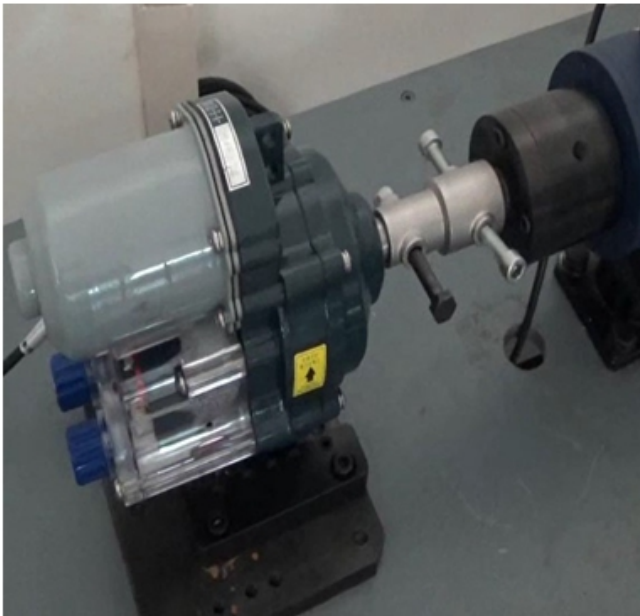

## Double Limit Switch Protection

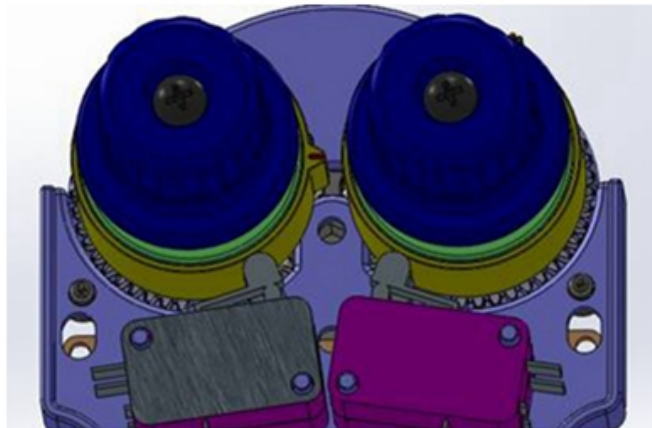

---

Accurate limit switch and low failure rate, failure rate is less than 0.5% within 5 years

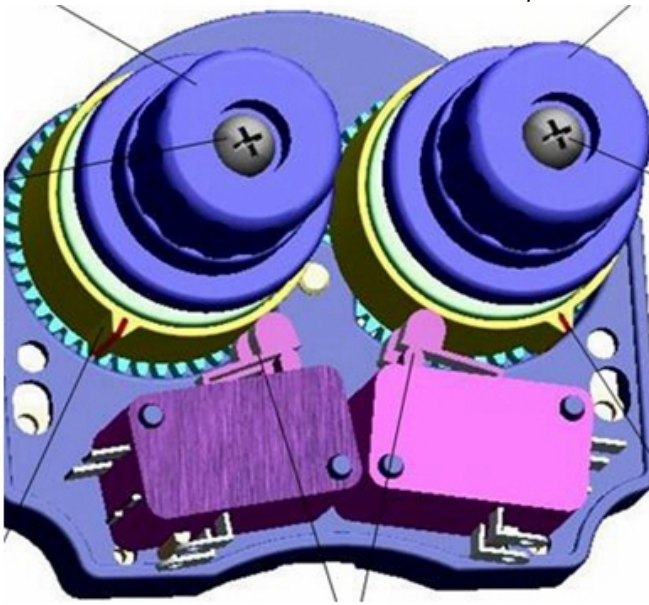

---

Ingress Protection Grade: IP55, Anti-condensation added to protect the safety of circuit diagram

Ingress  
Protection

{IPXX

Rating for ingress  
by liquids (1-9)

Rating for ingress  
by foreign objects  
and dust (1-6)



Various Power and Torque for Choosing

Product Code	Model	Voltage	Power	Torque	Current	Velocity	Rolling Distance	Rolling Length	Output Shaft Diameter	Rolling Pipe-OD	Weight	Guarantee
110419700010	GMD40-S	DC24V	40W	45N·m	≤3.0A	3.1r/min	4m	≤65m	Φ20	Φ22 or Φ27.5	2.6kg	3 years
110415400010	GMD60-S	DC24V	60W	60N·m	≤3.7A	2.8r/min	4m	≤85m	Φ20	Φ27.5 or Φ33.5	3.4kg	3 years
110415500010	GMD100-S	DC24V	100W	100N·m	≤6.2A	2.8r/min	4m	≤100m	Φ20	Φ27.5 or Φ33.5	3.6kg	3 years
110413100010	GMD100-S-K	DC24V	100W	100N·m	≤6.2A	2.8r/min	8m	≤100m	Φ20	Φ27.5 or Φ33.5	3.6kg	3 years
110415600010	GMD100-S-A1	DC24V	100W	100N·m	≤6.2A	2.8r/min	4m	≤100m	Φ20	Φ27.5 or Φ33.5	3.7kg	3 years
110415700010	GMD120-D	DC24V	120W	140N·m	≤7.5A	2.7r/min	4m	≤120m	Φ20	Φ27.5 or Φ33.5	5.6kg	3 years
110413200010	GMD180-S	DC24V	180W	180N·m	≤13.5A	3.3r/min	4m	≤120m	Φ22	Φ27.5 or Φ33.5	6.0kg	3 years

Internal and External Package





Certificate of Compliance



### 3 Years Guarantee

Quality-assured, from purchasing date, within the warranty period, FLC would do full compensate or replace them all for problematic products.

### Packing and Delivery



### Product Presentation

Product link : <https://www.wigglewires.com/?p=224208>